

West Seattle Bridge Program Virtual public meeting

July 21, 2021



City of Seattle



Español
Tiếng Việt
普通話

Audio Settings

Chat

Raise Hand

Q&A

Closed Caption

Interpretation

Leave

Ensuring the meeting is accessible

- The chat box and camera are not enabled for attendees
- You may submit questions throughout the meeting via the Q&A box at the bottom of the screen
- During the Q&A session, you may use the raise your hand feature to ask your question out loud
 - You will have 45 seconds to ask your question
- Shortcuts for screen-reader software include
 - Alt + Y to raise and lower your hand
 - Alt + A to mute and unmute

Agenda

- Overview presentation
 - Repair updates
 - Using the low bridge
 - Reconnect West Seattle
 - Stay local and plan ahead
 - Bridge replacement study
- Q&A session
- Adjourn



Thank you for your continued patience

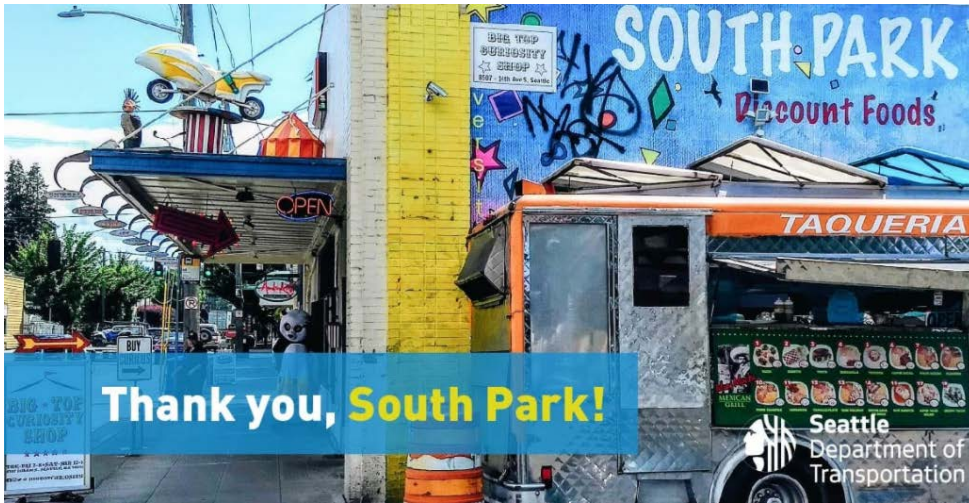

Question and Answer

Welcome to Q&A

Questions you ask will show up here. Only host and panelists will be able to see all questions.

Type your question here...





Polls

Repair updates

Heather Marx, SDOT

July 21, 2021



City of Seattle

What happened on the high bridge?

- Bridge has **been closed since March 2020** after **growing cracks were found** in the structure during a routine inspection.
- Cracking was **likely caused by insufficient post-tensioning** in the bridge as originally built.
 - Post-tensioning strands are cords that tighten the bridge and strengthen the concrete.
 - The bridge was built to the standards of the day
 - No specific defect or fault otherwise identified in our review of design and construction documents
- We **immediately set to work on emergency stabilization work**, which successfully halted the cracks from growing larger and kept the bridge standing.



Repair: The fastest path to reopening

- We know the bridge closure has created big challenges for the West Seattle and Duwamish Valley community.
- In November, Mayor Jenny Durkan announced that the bridge will be **repaired now and replaced in the future**
- Repair is the **fastest way** to restore mobility to West Seattle
- The bridge is on track to **reopen in mid-2022**



Bridge on track to reopen mid-2022



Update on Bridge Repair

What we have done:

- ✓ Secured funding
- ✓ Monitored the bridge to inform additional repairs
- ✓ Selected a construction contractor: *Kraemer North America*
- ✓ Applied to USDOT to be able to use a Community Workforce Agreement to hire workers from disadvantaged zip codes
- ✓ Reached the midway design milestone earlier this month

What's next:

- Finalizing repair design with Kraemer this fall
- Phase 2 (rehabilitation) construction to begin later this year
- **Bridge is on schedule to reopen in mid-2022**



Initial stabilization of the high bridge was completed at the end of 2020 by Kraemer North America, who will also lead the phase 2 (rehabilitation) work.

When will we see people working on the bridge?

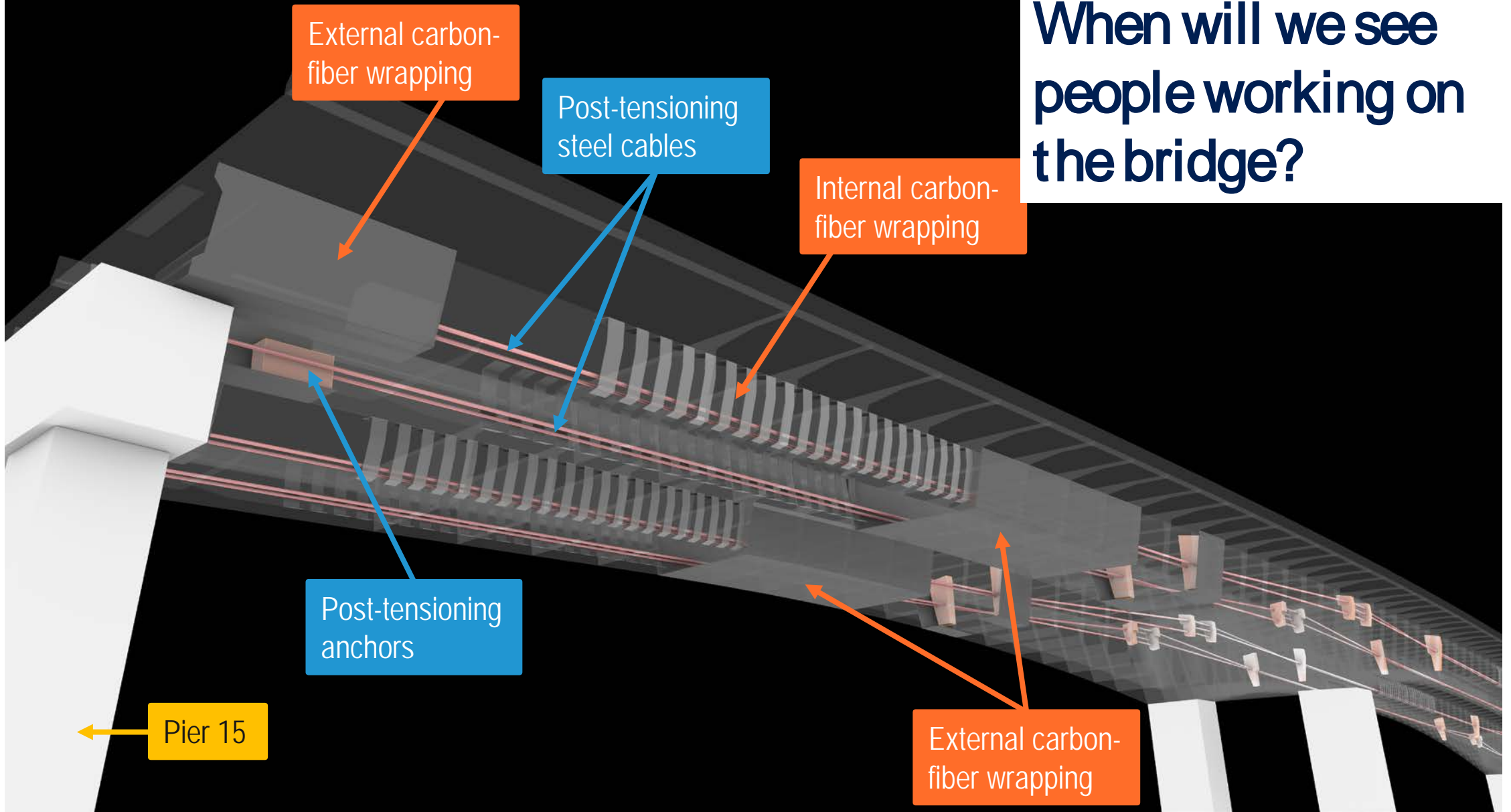

Using the Low Bridge

Maureen Sheehan, SDOT

July 21, 2021



City of Seattle

Spokane St Swing Bridge (Low Bridge)

- Closure of high bridge resulted in **loss of 7 travel lanes** to and from West Seattle
- Low bridge is one of the critical connections – but it can only carry about 1/5 of high bridge traffic
- Low bridge openings for marine vessels further restrict how many vehicles can use the bridge
- Limiting traffic on low bridge is **necessary to ensure emergency vehicles can get across**
- Restrictions in place today prioritize safe and timely passage for emergency response vehicles, transit, and freight

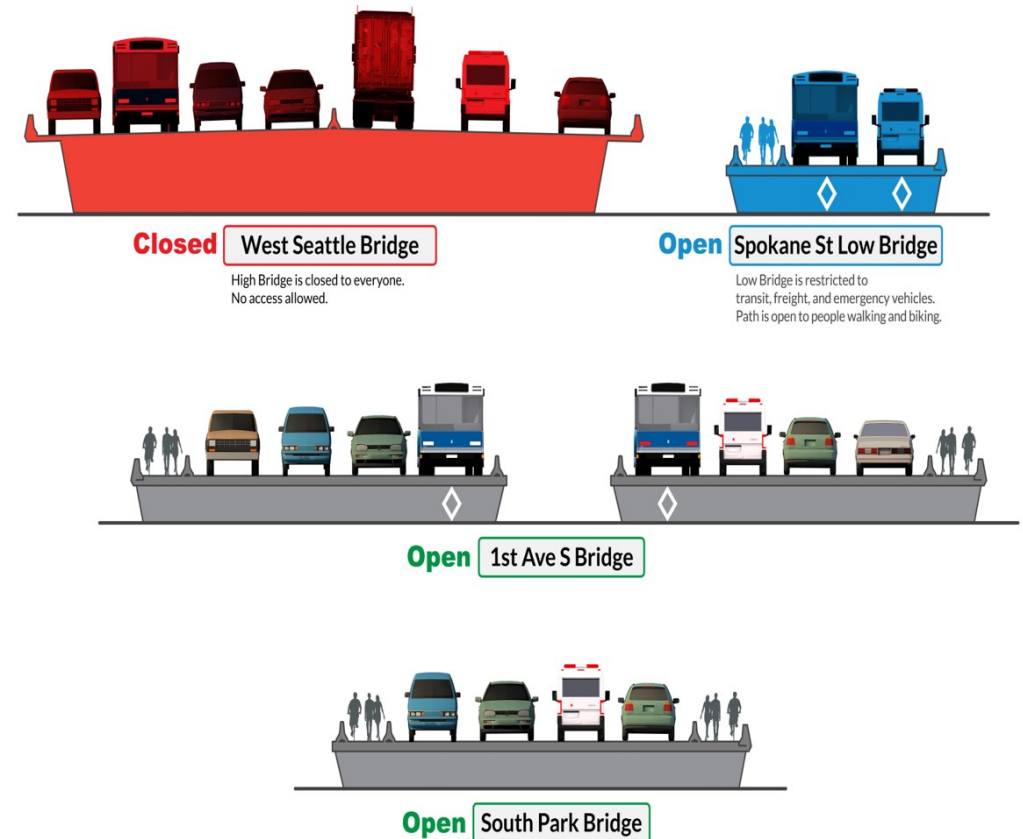

Don't go low!

- **\$75 ticket** for every time you drive across the low bridge without approval during restricted hours
- Restricted hours are **5 AM to 9 PM weekdays** and **8 AM to 9 PM weekends** (Saturday and Sunday)



REMINDERS

- We need to keep the low bridge clear for emergency vehicles, transit and freight.
- The low bridge is always open for all who are walking, biking, or rolling.

Who can use the low bridge?



Walking and biking are always allowed on the low bridge.

We've been granting **temporary** access to some travelers for urgent and unplanned trips across the low bridge after they apply and are approved:

- Individuals receiving lifesaving medical treatment
- On-call medical workers
- West Seattle-based restaurant and retail businesses
- Maritime/Industrial businesses
- International Longshore and Warehouse Union (ILWU) Members when dispatched across the Duwamish
- Government trips (City of Seattle, Port of Seattle, King County, WA state, Federal agencies, etc.)

All travelers must apply, show they meet the criteria and receive approval from SDOT before using the low bridge.

Think you meet the criteria? Apply for access at
seattle.gov/transportation/lowbridge

Low bridge access changes in early 2022



- There will be less temporary access in January 2022 for business and medical trips
- Terminal 5 will reopen, bringing many more freight trucks per day across the low bridge
- **How much less access?** SDOT is considering:
 - How many vehicles the bridge can carry per hour
 - How quickly traffic clears when the bridge opens for maritime vessels
 - Survey data from current users

Next Steps

- We will continue to **monitor low bridge capacity**
- We will continue to **apply what we have heard from community** about what access is most helpful
- We will continue to **share information about changes to low bridge access**. Stay connected and up-to-date by visiting our website and signing up for alerts.





Poll

Reconnect West Seattle

Sara Zora, SDOT

July 21, 2021



City of Seattle

Impacts of bridge closure

Bridge closure has caused major impacts for everyone

- Increased traffic and travel times
- Speeding and pedestrian safety
- Environmental and health impacts

Impacts especially tough on South Park, Highland Park and Georgetown - communities along the detour routes experiencing increased traffic through their neighborhoods

Bridge closure impacts are felt disproportionately by communities of color and low-income Seattleites

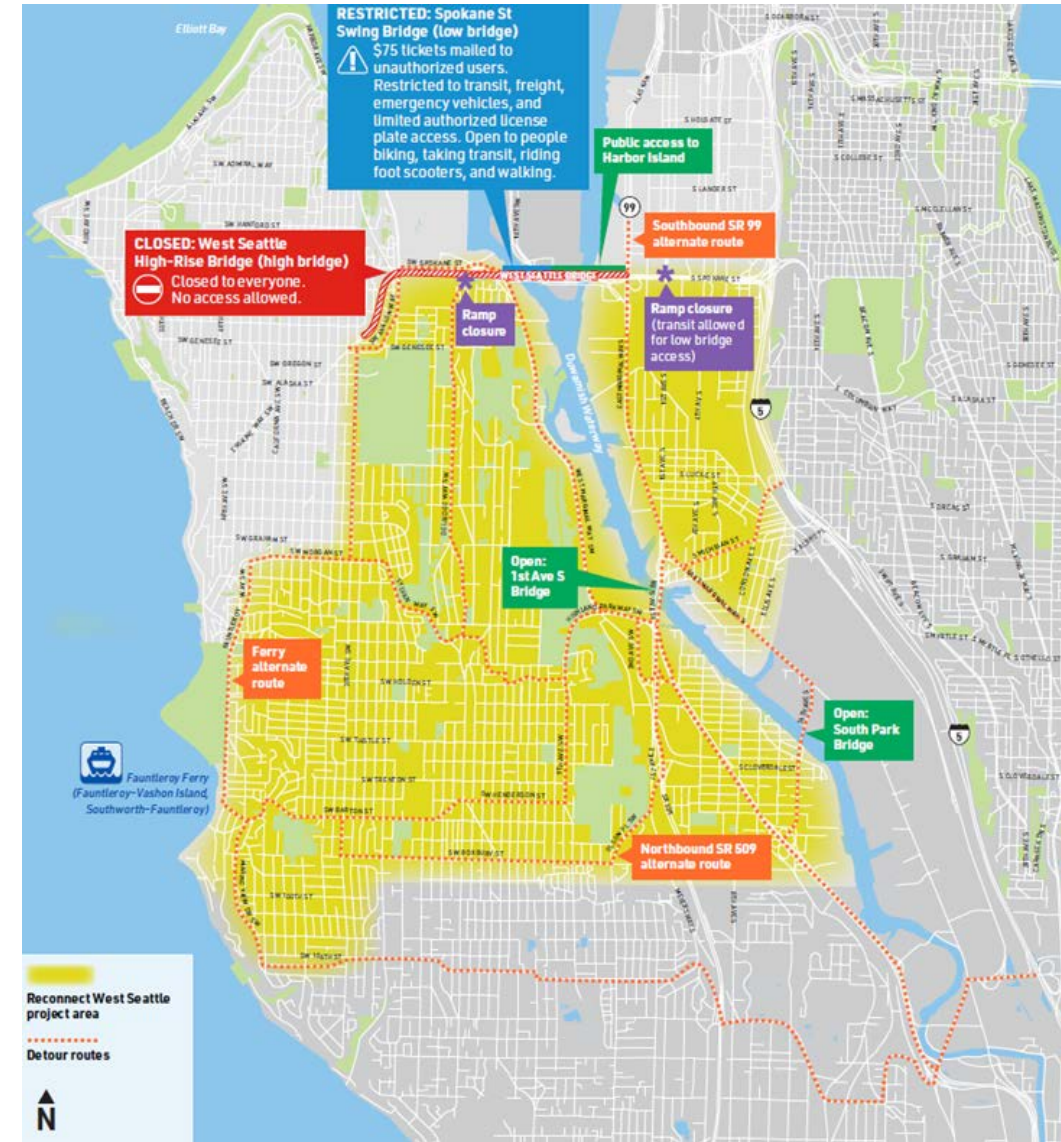

Improvements to help ease the impacts

- Over 200 traffic projects completed to help ease congestion and increase safety
- Continually revising traffic signal timing, signs, and real-time information
- Community selected projects for implementation

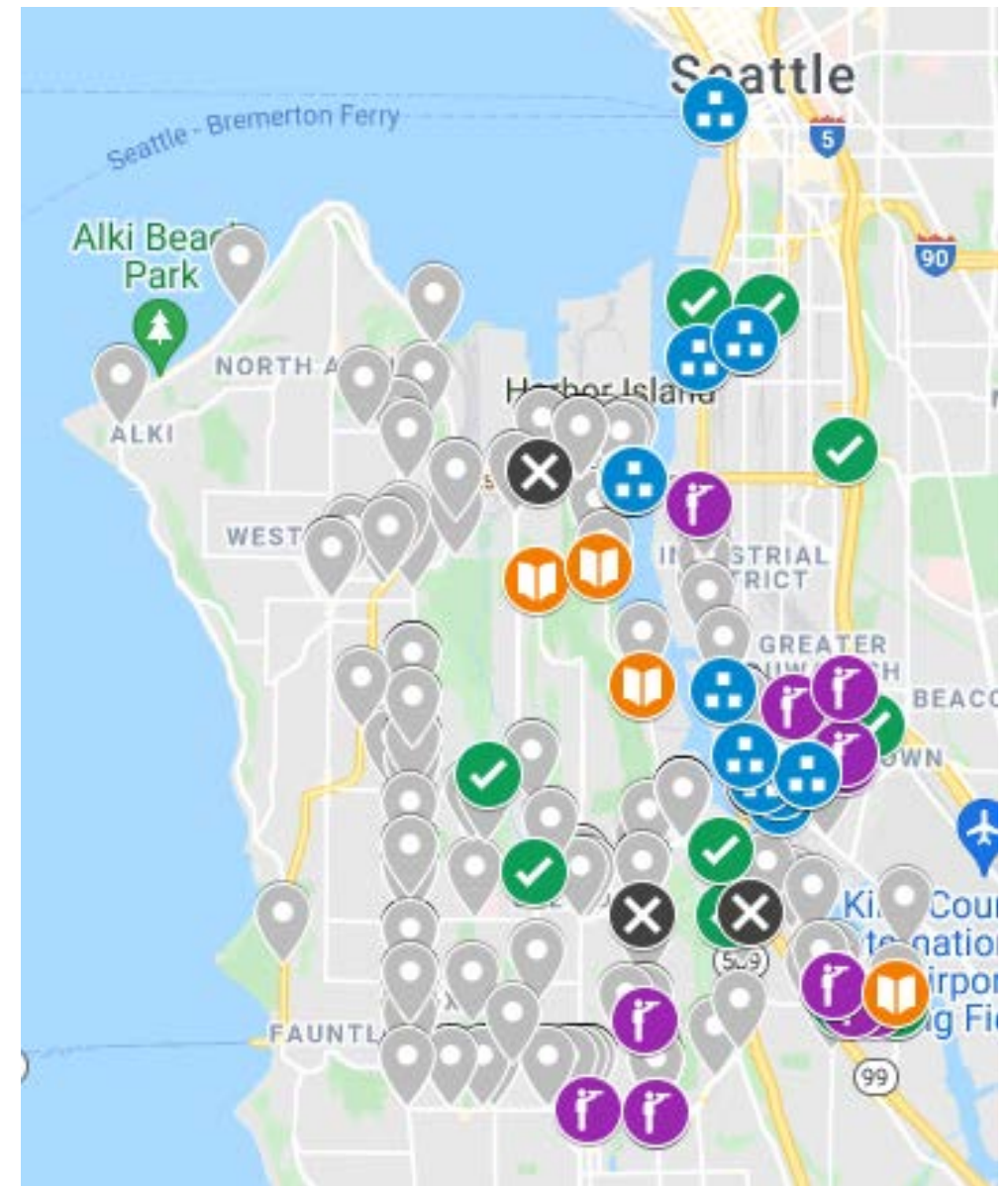

Home Zones

Slow vehicle speeds and make streets more walkable by adding:

- Speed humps
- Crosswalks
- Activation and beautification

In neighborhoods most impacted by **detour traffic** :

- South Park
- Highland Park
- Georgetown



West Marginal Way SW Improvements

Completed projects:

- 30 MPH speed limit signs and radar feedback signs
- Duwamish Longhouse west side sidewalk

Upcoming fall 2021 construction:

- Duwamish Longhouse interim signal and crosswalk
- Markings at business driveways to keep them clear

To be built after W Seattle Bridge reopens:

- Two-way protected bike lane and on-street parking



Improvements at West Marginal Way and Highland Park Way

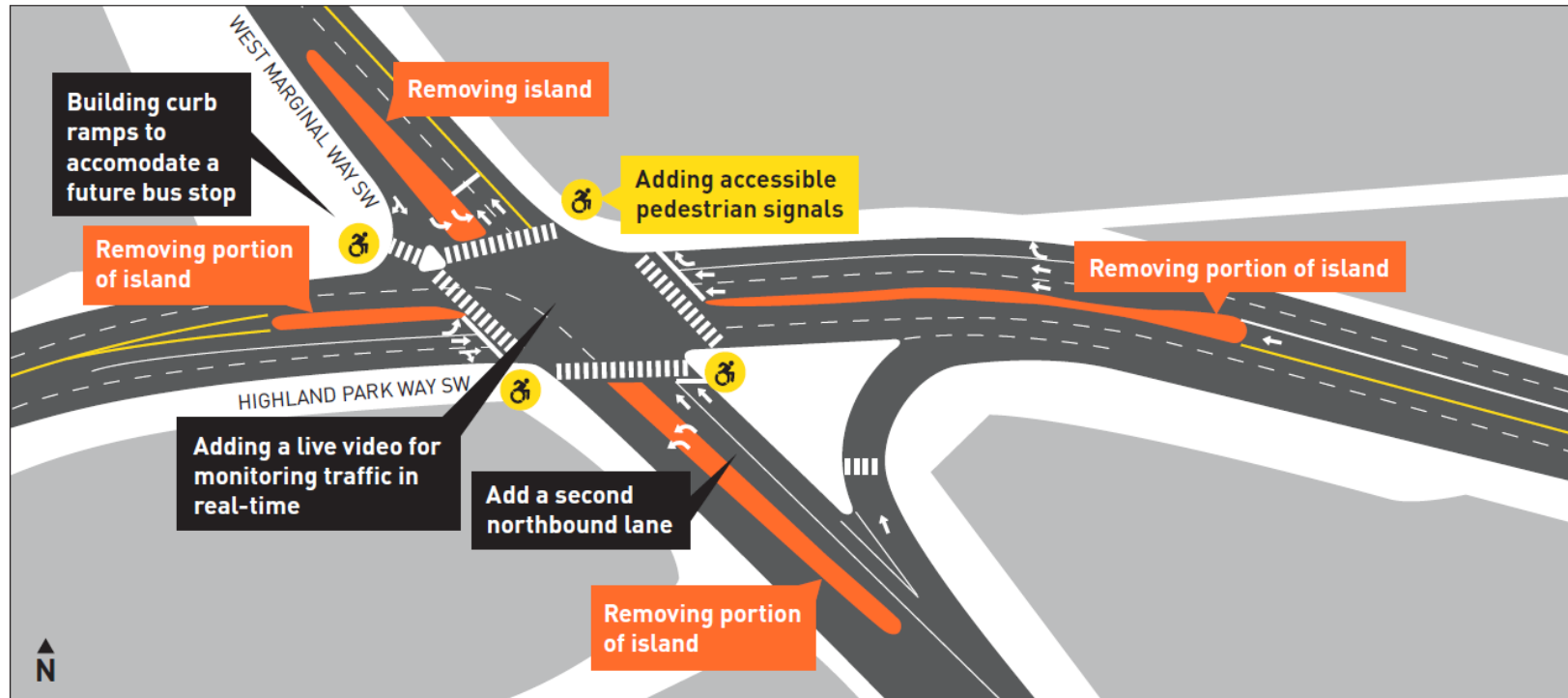

- Construction started July 17 to improve traffic flow
- Minimal impacts to traffic (mostly weekend work; starts as early as 3:00AM)
- Expected completion date: September 30

Be part of the response! Stay local and plan ahead

Sara Zora, SDOT

July 21, 2021



City of Seattle

One more year to go

- We have about one year between COVID-19 restrictions lifting and the high bridge reopening
- If we all drive across the detour bridges as much as we drove on the high bridge pre-COVID, the detour bridges would have about twice as much traffic as they can handle
- Let's avoid reaching that level of traffic congestion by working together



Seattle
Department of
Transportation

Hey, West Seattle!
Stay Local and Plan Ahead

As the city reopens, traffic on West Seattle detour routes will continue to increase.

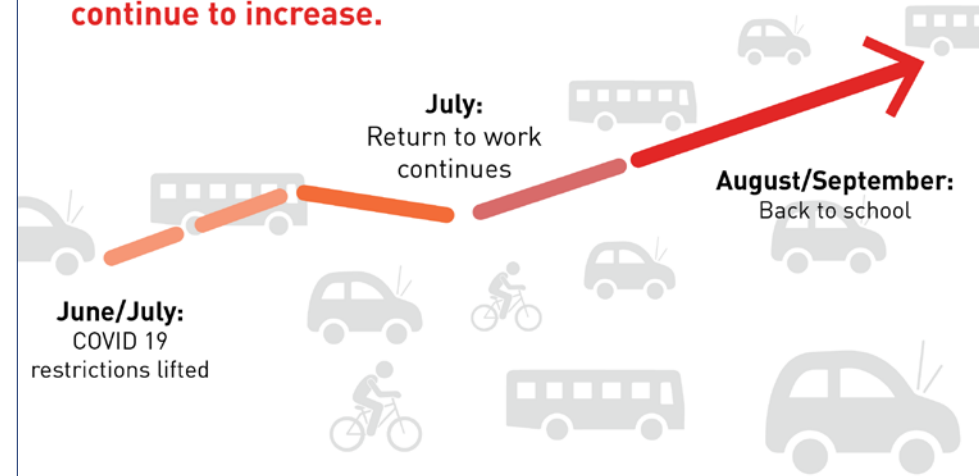

Save time and plan ahead before you leave.

Discover your travel options:

<https://bit.ly/traveloptions206>



What we are doing

- Adding 30,000 annual transit hours in West Seattle starting in October
- Partnering with other agencies, community, and businesses to offer and promote travel options
- Late August launching an incentive program in partnership with King County Metro to help communities learn about options and save money.
- Working with regional employers to promote working from home, vanpools and shuttle options, and biking



Sal the Salmon has tips for you to get around. Check Sal out on Social Media!

Your commute choices affect everyone

Changing how you commute is hard. Flipping one trip makes a difference!

- Walk, roll, bike or scoot
- Ride the bus or water taxi
- Carpool or vanpool
- Stay and shop local
- Travel outside peak hours, stay on detour routes, drive calmly, be a neighbor



Find helpful tips at our travel options website:
bit.ly/traveloptions206



Bridge replacement study

Wes Ducey, SDOT

July 21, 2021



City of Seattle

High-Rise Bridge eventual replacement

- Launched study in June for long-term replacement of the West Seattle Bridge
- Expect this complicated corridor will only become more challenging in the future
- Anticipate repaired bridge to last for decades
- Taking action now to ensure we are prepared to replace the bridge when the time comes

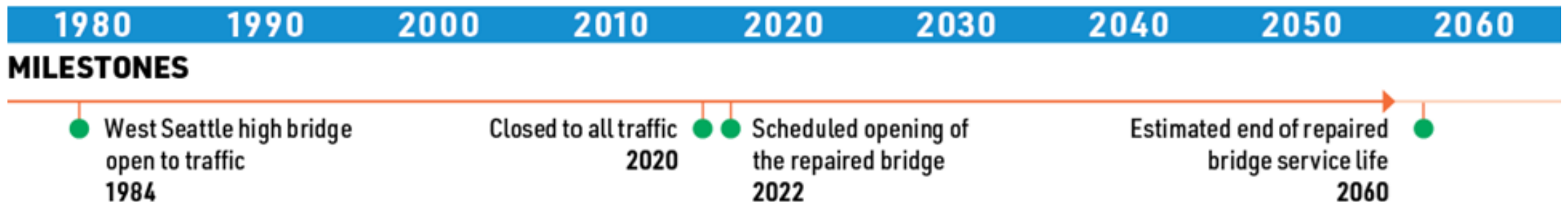

Why plan for replacement now?

- Follow Mayor Durkan's direction to **repair *and* plan for replacement**
- **Allow the city to respond much more quickly** in the unlikely event of another emergency
- **Understand the needs** of the corridor, including bicycle, pedestrian, and transit options; as well as **location opportunities**
- **First step of many** as we plan to replace the bridge at some point in the future

Next steps in City's Planning Study process

- Report on draft findings of the long-term replacement study in fall 2021
- Coordinate closely with Sound Transit and the Port of Seattle
- Complete concept and feasibility study by the end of 2021
- Visit our website for more information or to provide input

REPLACEMENT PLANNING STUDY SCHEDULE

| 2021 | | |
|--|---|--|
| June | Q3 | Q4 |
| <ul style="list-style-type: none">▪ Launch high bridge replacement planning scope and schedule | <ul style="list-style-type: none">▪ Feasibility findings▪ Introduce core concepts▪ Draft planning study | <ul style="list-style-type: none">▪ Final planning study |

Poll

Ways to stay up to date



Invite us to meet virtually with your group or organization



Email or call us to share your thoughts
WestSeattleBridge@seattle.gov or
(206) 400-7511



Visit our website to sign up for weekly email updates:

www.seattle.gov/WestSeattleBridge



Seattle
Department of
Transportation

West Seattle Bridge Weekly Update

Every Friday, we're sending this email to keep you informed about our progress to stabilize the bridge, our efforts to address traffic and mobility, and other items related to the West Seattle High-Rise Bridge closure.

In this week's update:

- [High-Rise Bridge Stabilization update](#)
- [This Weekend: Paving work on 16th Ave SW and Potential Striping on the Low Bridge](#)
- [November 16 Mayor's Virtual West Seattle Bridge Town Hall](#)
- [November 19 Community Task Force Meeting](#)



Temporary work platforms enable crews to do important stabilization work on the West Seattle High-Rise Bridge, and offer a unique view of the Low Bridge.

High-Rise Bridge Stabilization

Mayor Durkan Observes Progress

Mayor Jenny Durkan visited the West Seattle High-Rise Bridge in the wind and





Q&A session

Question and Answer

Welcome to Q&A

Questions you ask will show up here. Only host and panelists will be able to see all questions.

Type your question here...



Thank you!

seattle.gov/WestSeattleBridge

